

USE AND MAINTENANCE

- Use on level surfaces only
- Because this product needs assembly, it is prone to working itself loose from time to time depending on the use. Please take the time to check that all connections are still tight and working properly for safety.
- Only clean using a damp cloth and mild detergent, do not use bleach or abrasive cleaners.

Kids I'm a Big Helper Stool

PART LIST

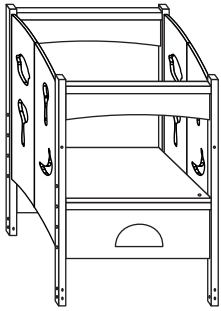

1 - Helper Assembly x1



2 - Safety Bar x2



3 - Safety Latch x2



4 - Foot x6



5 - Small Foot x2

HARDWARE



A - Screw x8



B - Wood Dowel x8



C - Small Screw x4

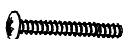

D - Long Screw x1

Assembly Instructions

①

Select and Expand 1 assembly. Fold out both sides and engage metal latches. Fold down helper step base panel and affix with D long screw.

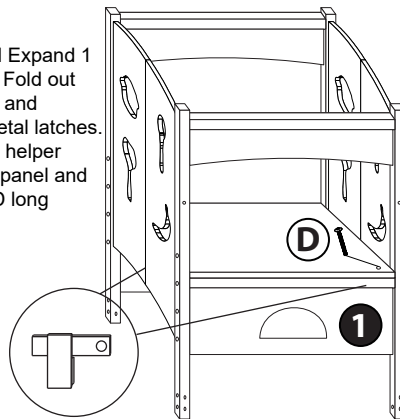

③

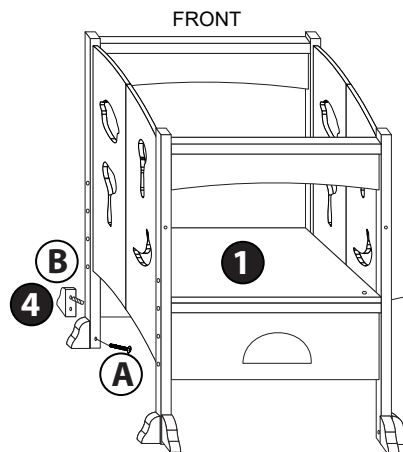

④

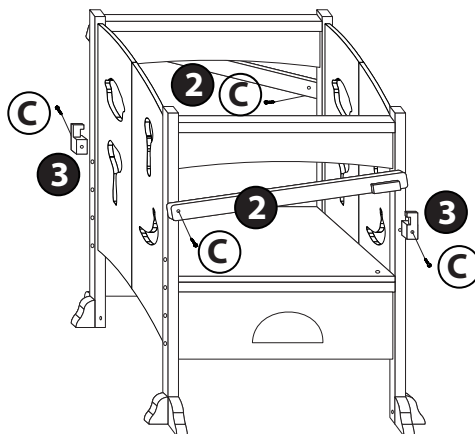

Select 2 and C screw. Insert C in hole in 2 and affix to back of assembly. Select 3 latch and C screw. Insert C in hole in 3 and affix to assembly. Repeat for other 2 and 3 on front side.

Note: Close Safety Bar onto latch when in use.

②

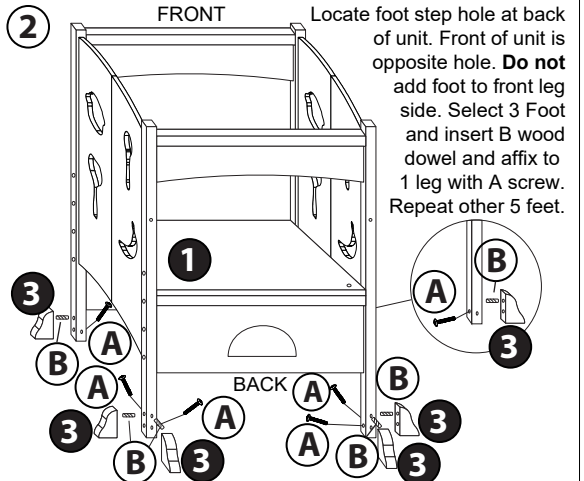

Select 4 Small Foot and insert B wood dowel and affix to Front Leg Side of 1 with A screw. Repeat for other 4 small foot.
Note: Small foot intended for counter side close fit when in use.

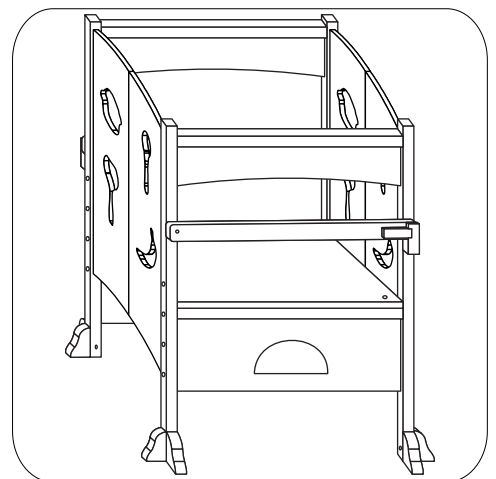
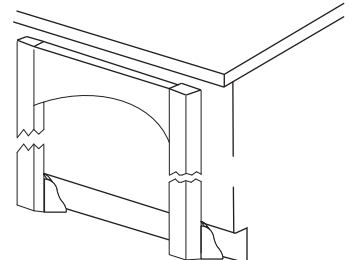

Congratulations! Setup of your new Naomi Home Kids I'm a Big Helper Stool is Complete!